

PROPERTY NOW OR FORMERLY
ROVERS FARM, INC.
DEED VOL. 640 PAGE 395
(OWNER ON BOTH SIDES OF STETSON ROAD)

PROPERTY NOW OR FORMERLY
ROVERS FARM, INC.
DEED VOL. 640 PAGE 395
(OWNER ON BOTH SIDES OF STETSON ROAD)

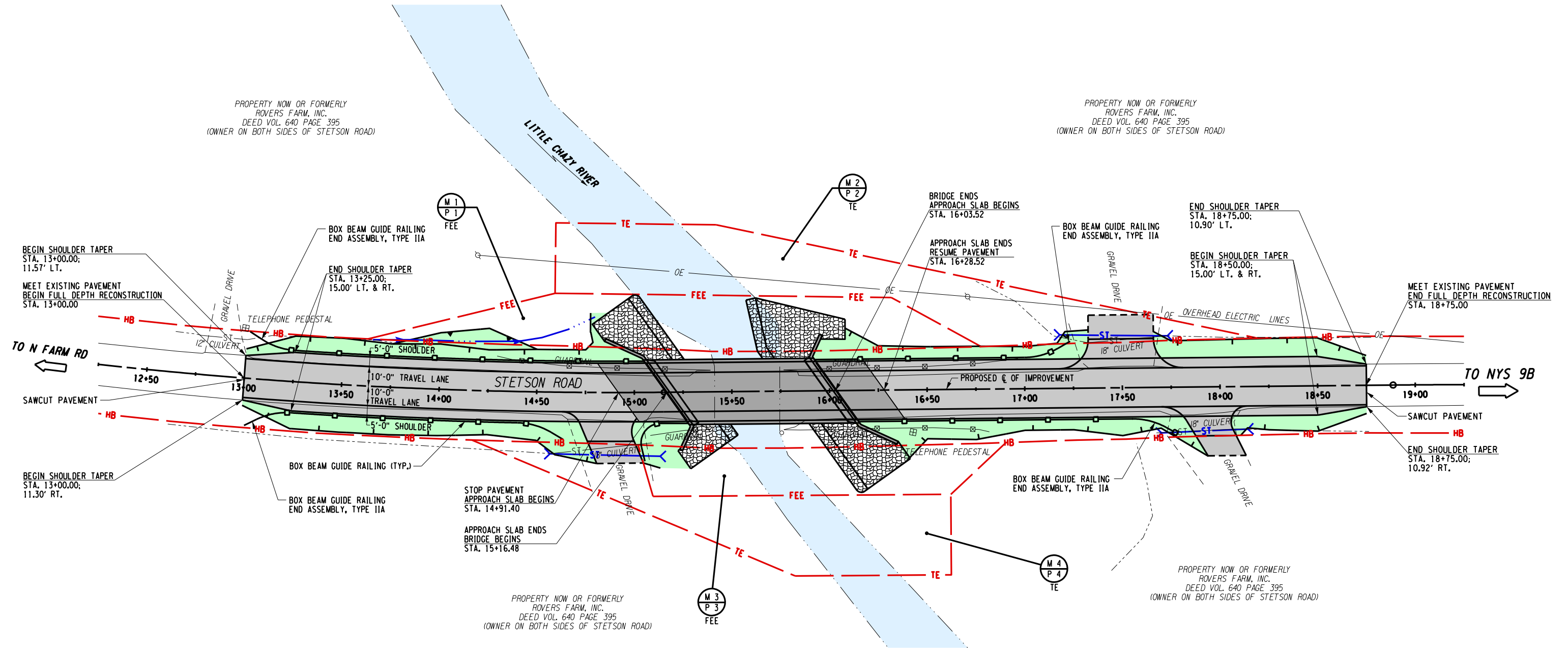

STETSON ROAD OVER THE LITTLE CHAZY RIVER
TOWN OF CHAZY, CLINTON COUNTY
PIN 7754.19, BIN 3336100
BRIDGE NY

LEGEND:

- PROPOSED BRIDGE AND APPROACH SLAB RECONSTRUCTION
- PROPOSED ROADWAY AND SHOULDER FULL DEPTH RECONSTRUCTION
- EARTHWORK LIMIT
- WATER



CLINTON COUNTY
HIGHWAY DEPARTMENT

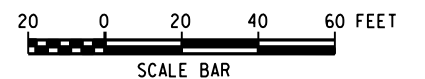

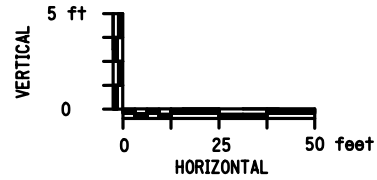
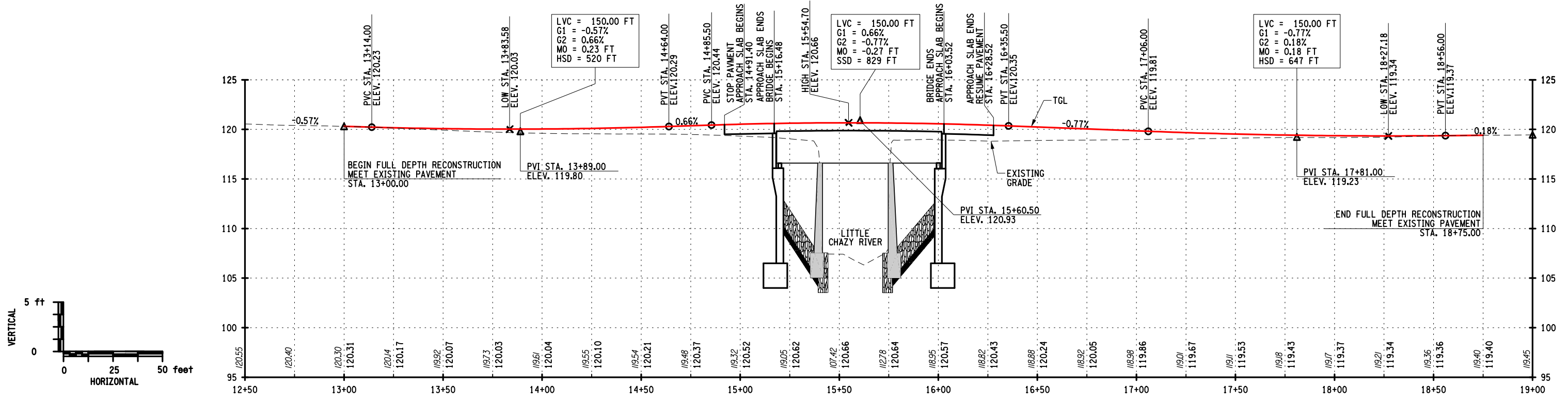

STETSON ROAD PROFILE

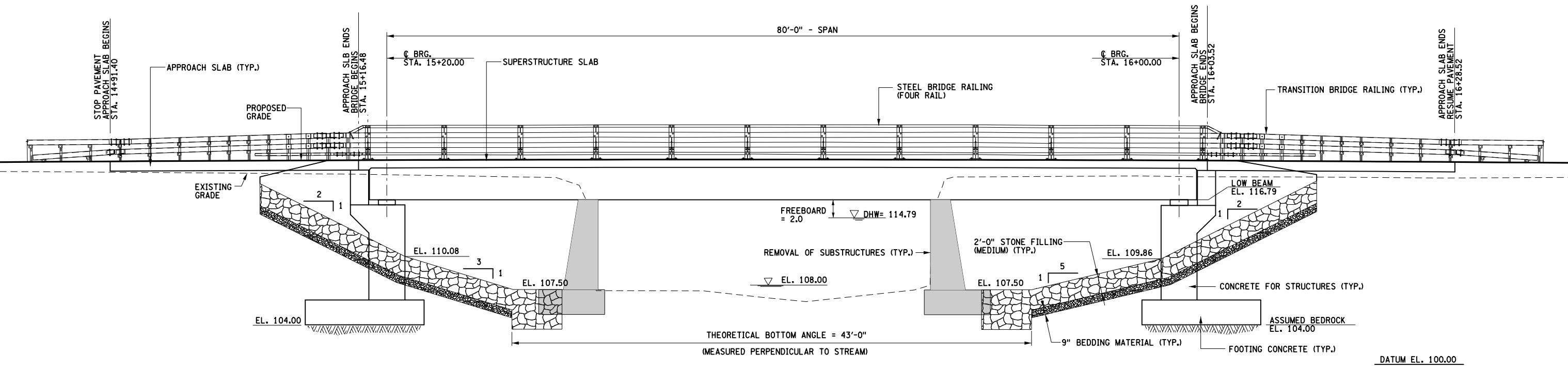

BRIDGE ELEVATION

STETSON ROAD OVER THE LITTLE CHAZY RIVER
 TOWN OF CHAZY, CLINTON COUNTY
 PIN 7754.19, BIN 3336100
 BRIDGE NY



CLINTON COUNTY
 HIGHWAY DEPARTMENT



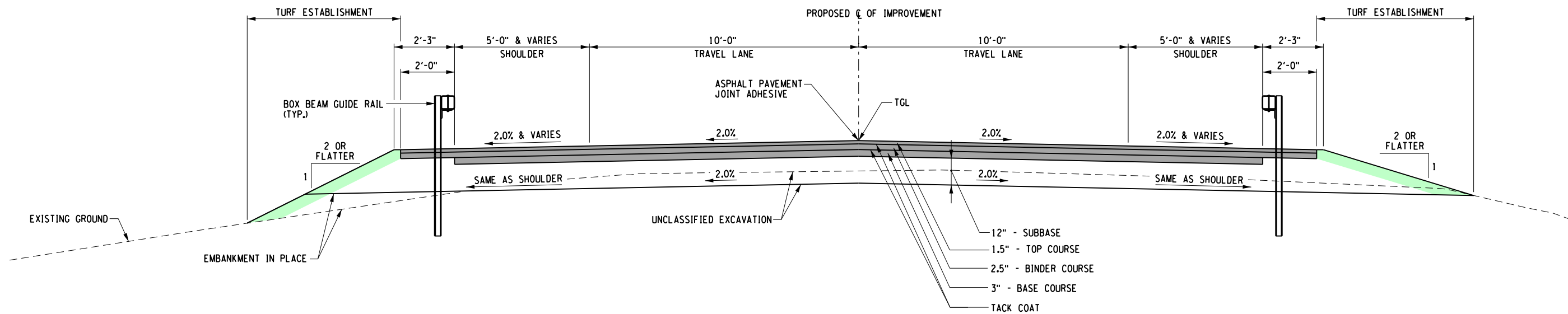

**TYPICAL HIGHWAY SECTION
FULL DEPTH RECONSTRUCTION**

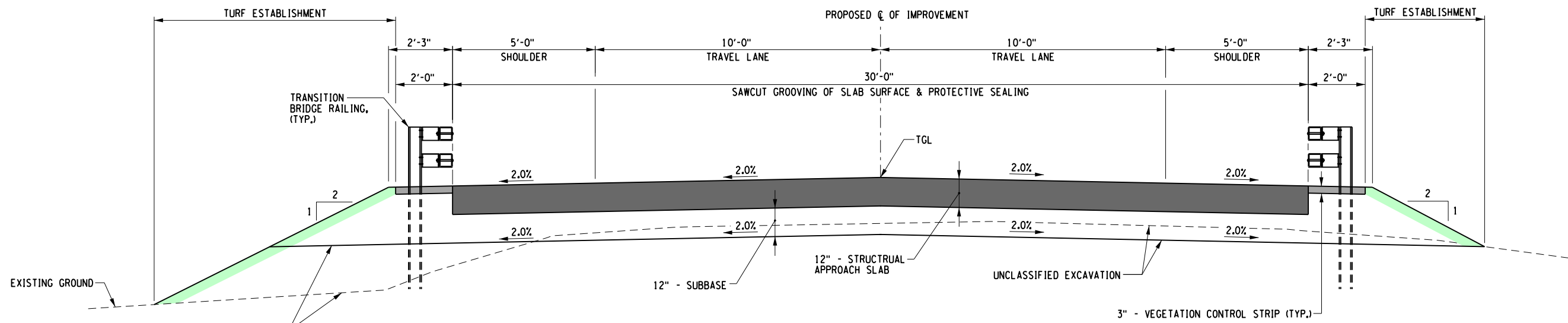

BRIDGE APPROACH SECTION

STETSON ROAD OVER THE LITTLE CHAZY RIVER
 TOWN OF CHAZY, CLINTON COUNTY
 PIN 7754.19, BIN 3336100
 BRIDGE NY

LEGEND:

- PROPOSED BRIDGE AND APPROACH SLAB RECONSTRUCTION
- PROPOSED ROADWAY AND SHOULDER FULL DEPTH RECONSTRUCTION
- EARTHWORK LIMIT



CLINTON COUNTY
HIGHWAY DEPARTMENT



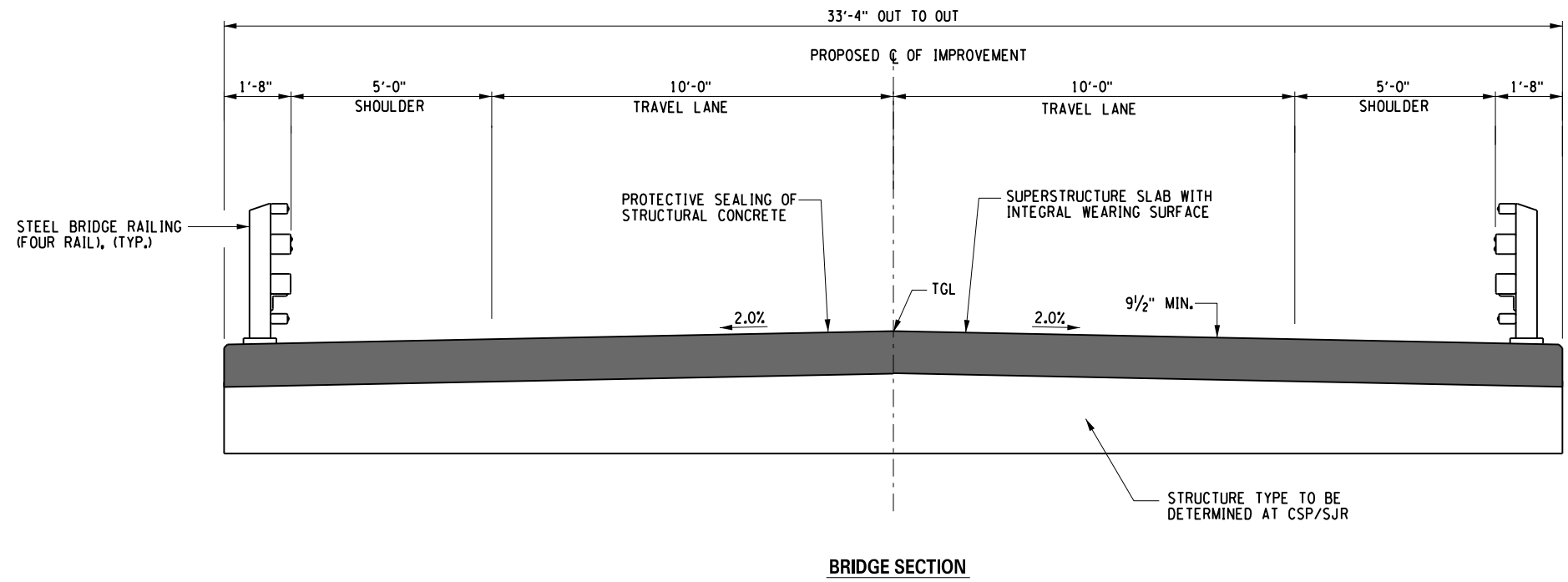

STETSON ROAD OVER THE LITTLE CHAZY RIVER
 TOWN OF CHAZY, CLINTON COUNTY
 PIN 7754.19, BIN 3336100
 BRIDGE NY

- LEGEND:**
- PROPOSED BRIDGE AND APPROACH SLAB RECONSTRUCTION
 - PROPOSED ROADWAY AND SHOULDER FULL DEPTH RECONSTRUCTION
 - EARTHWORK LIMIT



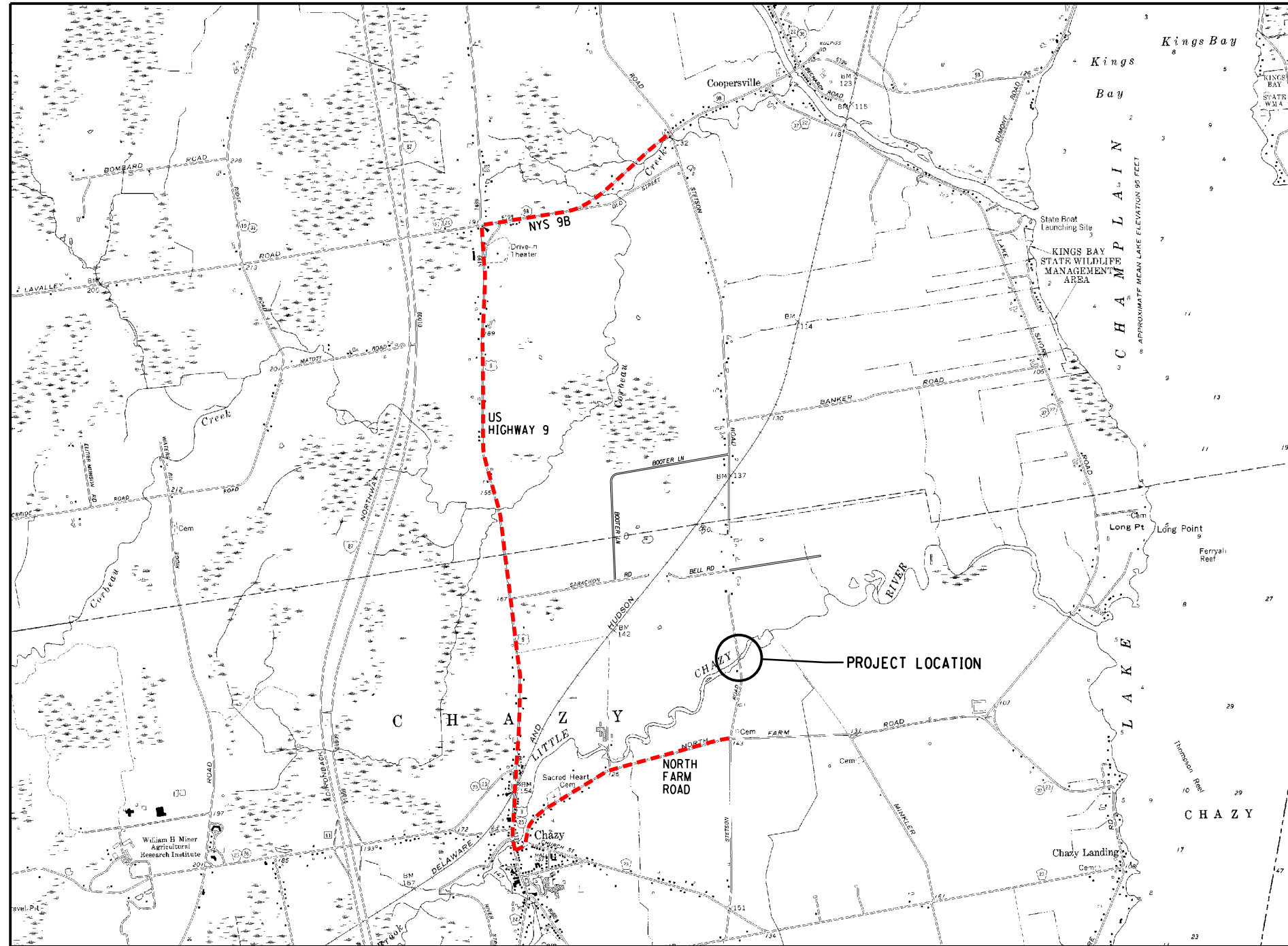

DETOUR ROUTE

**STETSON ROAD OVER THE LITTLE CHAZY RIVER
TOWN OF CHAZY, CLINTON COUNTY
PIN 7754.19, BIN 3336100
BRIDGE NY**

LEGEND:

- - - - - - DETOUR ROUTE



CLINTON COUNTY
HIGHWAY DEPARTMENT

